

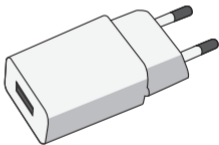

Danabridge V3

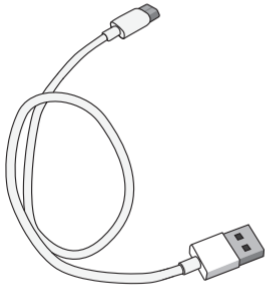



# A

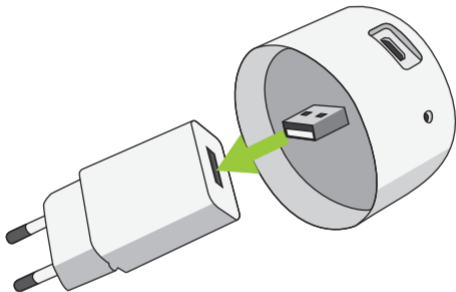

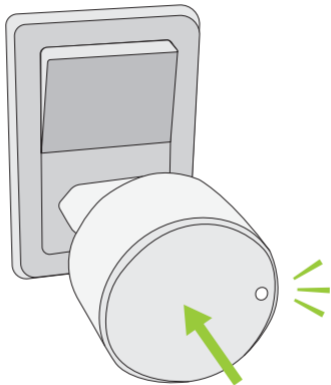

# B

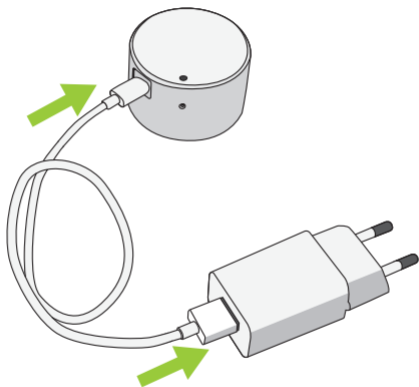

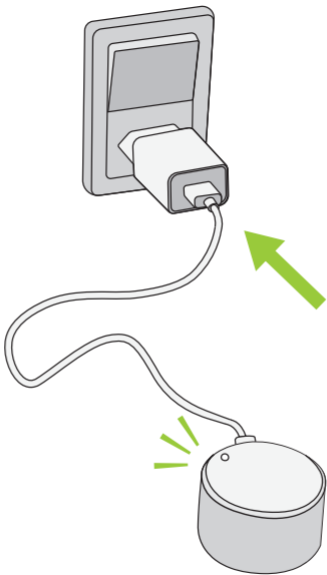

The following instructions are in english. Localized versions can be found with the QR-code below.



[guide.danalog.com](http://guide.danalog.com)

## Add the Danabridge V3 in the Danalock App

Open the Danalock App and add the Danabridge by selecting "Add device" in the menu tab. When the Danabridge has been enrolled you can pair it with your Danalock V3.

Go to:

**Menu > My Accessory Devices > *[Danabridge name]* > Pairing**

Select the lock you want to control with the Danabridge V3.

## Connect the Danabridge V3 to wifi

Go to:









**Menu > My Accessory Devices > *[Danabridge name]* > Wifi**

Select your access point and enter the credentials. The Danabridge V3 is ready for use when it has connected successfully.



## LED-Signals

The Danabridge V3 indicates the status of several operations with different colors:

LED signal	LED color	Status indication
Long white blink		Power on
Constant green light		Device is online
Constant red light		Device cannot access Wi-Fi
Yellow blinking		Device has not been configured
Red blinking		Device has no connection to server
Green blinking		Device communicating with server
Constant purple light		Device is ready to update
Blue while performing action		Device is updating

## Configuring the Danabridge V3 with click-commands

You can configure the Danabridge via the button found in the small hole on the side.

When you get to the setting you want to change, wait for 5 seconds and the Danabridge will react to your command. If you make a wrong number of clicks, just stop at a number of clicks where the LED doesn't light up and wait for 5 seconds. The LED will flash red to indicate that it has timed out.

Clicks	Color	Activity
10	Red	Reset user settings
This action deletes all user settings on the Danabridge.		

## Firmware upgrade

Go to:

**Menu > My Accessory Devices > [Danabridge name] > Firmware**

and press "Upgrade firmware". Make sure to keep your phone near the Danabridge V3 during the entire firmware upgrade process.



## Simple Guidelines

Please follow these guidelines when configuring, using, or recycling the DBV3. Violating these guidelines may be dangerous, illegal, or otherwise detrimental. Further detailed information is provided in this manual.

## Terms of use

This equipment design is primarily for indoor use mounted in a standard electrical outlet. Use only Danalock approved accessories for the DBV3. Do not connect incompatible products, and do not operate the DBV3 where wireless radio communication is prohibited. Like hospitals, buildings near blasting sites etc.

## Do Not Operate Where Prohibited

Do not allow the DBV3 unit to operate wherever wireless radio communication use is prohibited or when doing so may cause interference or danger as the DBV3 cannot be turned off after installation.

Device Operation and human exposure to electromagnetic fields

The DBV3 unit is a low power radio transmitter and receiver. Periodically the DBV3 wakes up either due to activity or by a timer. When it is ON, it receives and sends out radio frequency (RF) signals for a short period of time.

## Specific Human Absorption Ratio (SAR)

The DBV3 unit is not intended for handheld use or to be worn on the body. A minimum separation of eight (8") inches (20 cm) is to be maintained between the DBV3 and any persons' body.

## Pacemakers and other Medical Devices

If any other personal medical devices are used in the vicinity of a DBV3 unit, consult the manufacturers of the medical devices to determine if they are adequately shielded from external RF energy. Physicians may be able to assist in obtaining this information.

## Interference

Like all wireless devices, the DBV3 may encounter electrical interference that may affect its performance. The DBV3 is tested and certified according to international and European standards. The performance hereof ensures correct operation in the presence of electromagnetic interference and/or electrostatic discharge.

## Category of use

The DBV3 WiFi interface is an accessory to other Danalock products and will only work together with these to access the internet.

## Security for electrical functions

The DBV3 has no indications, sound alarms in case of a connected lock malfunction.

## Security for electrical manipulation

The DBV3 is tested compliance to the EMC requirement laid out in the 2014/53/EU directive. The performance hereof ensures correct operation in the presence of electromagnetic interference and/or electrostatic discharge.

## Children

The DBV3 series and its accessories are not used to solicit data from or market to children

## CE and UKCA mark

The DBV3 complies with the essential requirements of the RED directive 2014/53/EU and Radio Equipment Regulations 2017 - UK SI 2017 No. 1206 with respect to radio spectrum, EMC, Health and safety. EU Certificate and Declaration of conformity (DOC) can be downloaded from the webpage

<https://danalock.com/legal/certificates/>

## Accessory manufacturer information: Power adaptor

MOVEFOREST ELECTRICAL APPLIANCE (HK) CO LTD  
Office 3A-9, 12 FI Kaiser Ctr, No 18 Ctr St Sai Yin Purn,  
HONG KONG

## Product specifications

Supply Voltage	Via USB	5V DC, 1A
Temperature range	Active operating mode	0°C to +40°C
	Storage	5°C to +40°C
Mechanical specifications	Dimensions (D x H)	53 mm x 32 mm
	Weight	36 g
Material	Plastic	White ABS
Radio interfaces	WiFi	Max 12 dBm
	Bluetooth LE	Max 4 dBm

## Warranty

Danalock ApS products are covered by a limited manufacturer warranty. The Danalock ApS warranty is limited to the warranty rules and legislation present in each country. The warranty only covers manufacturing faults. The warranty does not cover misuse, wrong installation or damage due to a faulty installation or wrong maintenance.

The invoice act as the proof of warranty, so please keep it as reference for any warranty complaints.

## Qualified Service

The Danabrige V3 contains no user serviceable or replaceable parts. Non-functioning units must be returned to an authorized service center for repair or replacement.

## Technical Assistance

If you have a problem and cannot find the information you need in the product

documentation, please contact Danalock ApS at support@danalock.com. Please have the following information ready:

1. Serial number (preferred), MAC address or alias of the lock
2. Username used when registering / installing the lock
3. Username used when getting the error (if different username)
4. Time of incident

## US and Canada certification marks

This device contains radio transmitters that comply with CFR 47 part 2.1091, part 15.207, Part 15.247 of the FCC rules and with RSS-GEN, RSS-102 and RSS-247 of Industry Canada requirements

### **Notice statements according to CFR 47 Part 15.19 / RSS-GEN:**

The device complies with Part 15 of the FCC rules and with Industry Canada license

exempt standard(s). Operation is subject to the following two conditions:

- (1) This device may not cause harmful interference, and
- (2) This device must accept any interference received, including interference

that may cause undesired operation.

### **Déclarations selon le CFR 47 section 15.19 / RSS-GEN:**

Le présent appareil est conforme aux CNR d'Industrie Canada applicables aux appareils

radio exempts de licence. L'exploitation est autorisée aux deux conditions suivantes:

- (1) l'appareil ne doit pas produire de brouillage, et
- (2) l'utilisateur de l'appareil doit accepter tout brouillage radioélectrique subi, même si le brouillage est susceptible d'en compromettre le fonctionnement.

### **NOTICE statements according to CFR 47 Part 15.21:**

Changes or modifications made to this equipment not expressly approved by Danalock Aps may void the FCC authorization to operate this equipment.

Statements according to CFR 47 Part 2.1091 and RSS-102:

With respect to radiofrequency radiation exposure Information it is declared that this equipment complies with FCC radiation exposure limits set forth for an uncontrolled environment.

This equipment should be installed and operated with minimum distance of 20 cm between the radiator and your body.

This transmitter must not be co-located or operating in conjunction with any other antenna or transmitter.

### **Déclarations selon le CFR 47 Sections 2.1091 et RSS-102:**

Respectant les informations relatives à l'exposition aux radiations de fréquences radio, on déclare que cet équipement respecte les limites d'exposition aux radiations de la FCC aux conditions prévues pour un environnement non contrôlé.

Cet équipement doit être installé et fonctionner à une distance minimale de 20 cm entre l'appareil irradiant et votre corps.

Cet émetteur ne doit pas être installé ou utilisé en conjonction avec d'autres antennes ou d'autres émetteurs.

### **FCC part 15B note**

This equipment has been tested and found to comply with the limits for a Class B digital device, pursuant to part 15 of the FCC Rules. These limits are designed to provide reasonable protection against harmful interference in a residential installation. This equipment generates, uses

and can radiate radio frequency energy and, if not installed and used in accordance with the instructions, may cause harmful interference to radio communications. However, there is no guarantee that interference will not occur in a particular installation. If this equipment does cause harmful interference to radio or television reception, which can be determined by turning the equipment off and on, the user is encouraged to try to correct the interference by one or more of the following measures:

- Reorient or relocate the receiving antenna.
- Increase the separation between the equipment and receiver.
- Connect the equipment into an outlet on a circuit different from that to which the receiver is connected.

#### Australia and New Zealand

This product complies with the AS/NZS 4268 requirements for Bluetooth LE transceiver (2402 MHz ~ 2480 MHz) and WiFi transceivers (IEEE 802.11b/g/n-HT20): 2412MHz ~ 2472MHz.

The product complies with the requirements of the relevant ACMA Standards made under the Radiocommunications Act 1992 and the Telecommunications Act 1997, by the Supplier's Declaration of Conformity (SDOC). These Standards are referenced in notices made under section 182 of the Radiocommunications Act and 407 of the Telecommunications Act.

The product complies with the requirements of the relevant standards under Section 134 (1) (g) of the New Zealand Radiocommunications Act 1989, by the Supplier's Declaration of Conformity (SDOC)

#### Japan

The product is approved in Japan with the certificate ID n°:  
**[R] 204-820373**

This device is granted pursuant to the Japanese Radio Law (電波法)

=当該機器には電波法に基づく、技術基準適合証明等を受けた特定無線設備を装着

している

This device should not be modified (otherwise the granted designation number will become invalid)

本製品の改造は禁止されています。(適合証明番号などが無効となります。)

#### Regulatory labeling:

The Danabridge V3 product are regulatory compliant to the following regulation (Europe, USA/Canada, Japan, Australia/NZ):



 **[R] 204-820373**

**FCC ID: 2ADSH-DBV3**  
**IC: 12588A-DBV3**



**Danalock ApS**

Gammel Stillingvej 427C  
8462 Harlev, DK

+45 4242 8122  
info@danalock.com

[www.danalock.com](http://www.danalock.com)